

Section 4.

Metric Timing Pulley & Bar Stock (T5 -T10 -AT5 -AT10)

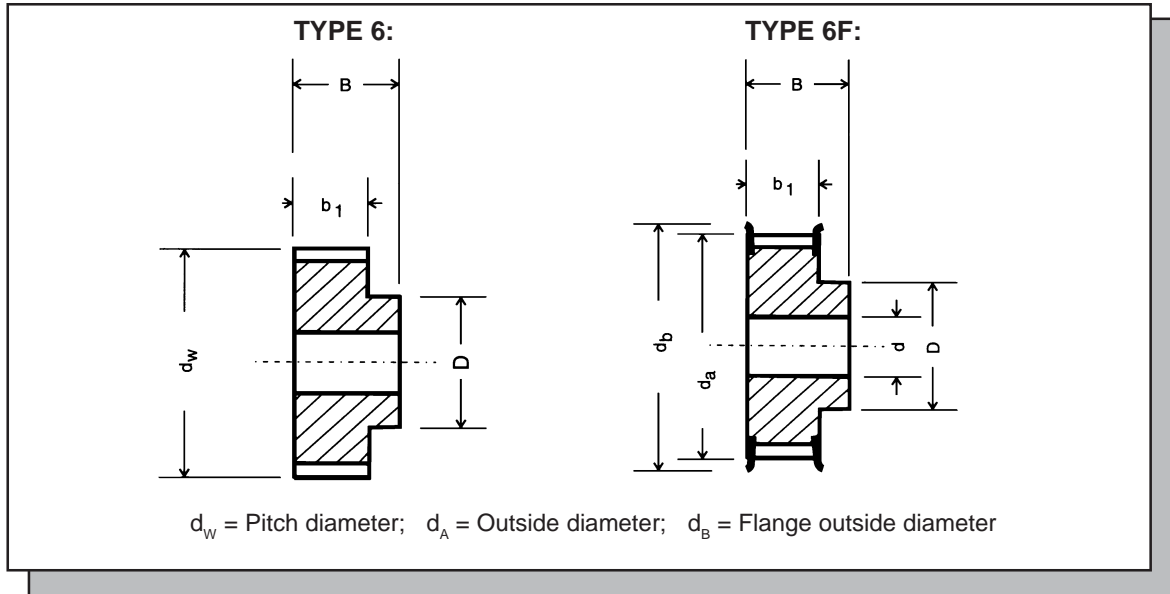

PART NUMBER EXAMPLE:

40T10/24-2

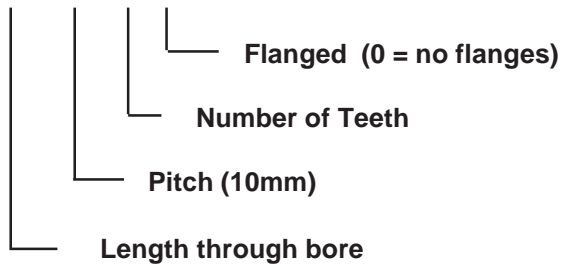

NOTE: PART NUMBERS INDICATE LENGTH THROUGH BORE - NOT BELT WIDTH:

T5 - AT5 BELT WIDTH:

- 10mm
- 16mm
- 25mm

PULLEY PART NUMBER PREFIX:

- 21
- 27
- 36

T10 - AT10 BELT WIDTH:

- 16mm
- 25mm
- 32mm
- 50mm

PULLEY PART NUMBER PREFIX:

- 31
- 40
- 47
- 66

T5 Pitch– For Belt Width 10mm

Metric Timing Belt Pulleys

Part Number	List Price	Number of Teeth	Pulley Type	Material	d _w (mm)	d _a (mm)	d _B (mm)	b ₁ (mm)	B (mm)	D (mm)	Pilot bore d (mm)	Finished bore d _{max} (mm)	Weight Kg
21 T5/10-2	28.30	10	6F	Al	16.05	15.05	19.5	15	21	8	–	5	0.012
21 T5/12-2	29.41	12	6F	Al	19.25	18.25	23.0	15	21	11	–	6	0.016
21 T5/14-2	30.76	14	6F	Al	22.45	21.45	25.0	15	21	14	–	8	0.019
21 T5/15-2	31.20	15	6F	Al	24.05	23.05	28.0	15	21	16	6	10	0.021
21 T5/16-2	31.88	16	6F	Al	25.60	24.60	32.0	15	21	18	6	11	0.025
21 T5/18-2	33.66	18	6F	Al	28.80	27.80	32.0	15	21	20	6	12	0.031
21 T5/19-2	34.29	19	6F	Al	30.40	29.40	36.0	15	21	22	6	12	0.036
21 T5/20-2	36.14	20	6F	Al	32.00	31.00	36.0	15	21	24	6	14	0.038
21 T5/22-2	38.05	22	6F	Al	35.25	34.25	38.0	15	21	24	6	15	0.046
21 T5/24-2	39.29	24	6F	Al	38.50	37.40	42.0	15	21	26	6	15	0.054
21 T5/25-2	39.85	25	6F	Al	40.00	39.00	44.0	15	21	26	6	15	0.058
21 T5/26-2	41.41	26	6F	Al	41.60	40.60	44.0	15	21	26	6	16	0.062
21 T5/27-2	41.76	27	6F	Al	43.20	42.20	48.0	15	21	30	8	18	0.064
21 T5/28-2	42.11	28	6F	Al	44.75	43.75	48.0	15	21	32	8	18	0.071
21 T5/30-2	43.18	30	6F	Al	47.95	46.95	51.0	15	21	34	8	18	0.075
21 T5/32-2	45.09	32	6F	Al	51.10	50.10	54.0	15	21	38	8	22	0.088
21 T5/36-2	48.49	36	6F	Al	56.45	56.45	63.0	15	21	38	8	22	0.114
21 T5/40-2	53.31	40	6F	Al	63.85	62.85	66.0	15	21	40	8	23	0.138
21 T5/42-2	58.47	42	6F	Al	67.00	66.00	71.0	15	21	40	8	24	0.180
21 T5/44-0	60.15	44	6	Al	70.20	69.20	–	15	21	45	8	26	0.185
21 T5/48-0	61.39	48	6	Al	76.55	75.55	–	15	21	50	8	28	0.200
21 T5/60-0	75.53	60	6	Al	95.65	94.65	–	15	21	65	8	35	0.307

T5 Pitch– For Belt Width 16mm

Metric Timing Belt Pulleys

Part Number	List Price	Number of Teeth	Pulley Type	Material	d _w (mm)	d _a (mm)	d _B (mm)	b ₁ (mm)	B (mm)	D (mm)	Pilot bore d (mm)	Finished bore d _{max} (mm)	Weight Kg
27 T5/10-2	30.76	10	6F	Al	16.05	15.05	19.5	21	27	8	–	5	0.016
27 T5/12-2	31.88	12	6F	Al	19.25	18.25	23.0	21	27	11	–	6	0.022
27 T5/14-2	33.12	14	6F	Al	22.45	21.45	25.0	21	27	14	–	8	0.026
27 T5/15-2	33.68	15	6F	Al	24.05	23.05	28.0	21	27	16	6	10	0.029
27 T5/16-2	36.82	16	6F	Al	25.60	24.60	32.0	21	27	18	6	11	0.035
27 T5/18-2	38.05	18	6F	Al	28.80	27.80	32.0	21	27	20	6	12	0.043
27 T5/19-2	38.61	19	6F	Al	30.40	29.40	36.0	21	27	22	6	12	0.049
27 T5/20-2	39.85	20	6F	Al	32.00	31.00	36.0	21	27	24	6	14	0.053
27 T5/22-2	43.83	22	6F	Al	35.25	34.25	38.0	21	27	24	6	15	0.054
27 T5/24-2	46.02	24	6F	Al	38.40	37.40	42.0	21	27	26	6	15	0.076
27 T5/25-2	46.58	25	6F	Al	40.00	39.00	44.0	21	27	26	6	15	0.081
27 T5/26-2	48.26	26	6F	Al	41.60	40.60	44.0	21	27	26	6	16	0.085
27 T5/27-2	49.61	27	6F	Al	43.20	42.20	48.0	21	27	30	8	18	0.090
27 T5/28-2	50.05	28	6F	Al	44.75	43.75	48.0	21	27	32	8	18	0.092
27 T5/30-2	50.28	30	6F	Al	47.95	46.95	51.0	21	27	34	8	18	0.105
27 T5/32-2	50.95	32	6F	Al	51.10	50.10	54.0	21	27	38	8	22	0.123
27 T5/36-2	53.31	36	6F	Al	57.45	56.45	63.0	21	27	38	8	22	0.160
27 T5/40-2	60.72	40	6F	Al	63.85	62.85	66.0	21	27	40	8	23	0.193
27 T5/42-2	63.98	42	6F	Al	67.00	66.00	71.0	21	27	40	8	24	0.205
27 T5/44-0	66.81	44	6	Al	70.20	69.20	–	21	27	45	8	26	0.228
27 T5/48-0	68.80	48	6	Al	76.55	75.55	–	21	27	50	8	28	0.280
27 T5/60-0	85.29	60	6	Al	95.65	94.65	–	21	27	65	8	35	0.430

Al = Aluminum

T5 Pitch– For Belt Width 25mm

Metric Timing Belt Pulleys

Part Number	List Price	Number of Teeth	Pulley Type	Material	d _w (mm)	d _a (mm)	d _B (mm)	b ₁ (mm)	B (mm)	D (mm)	Pilot bore d (mm)	Finished bore d _{max} (mm)	Weight Kg
36 T5/10-2	33.12	10	6F	Al	16.05	15.05	19.5	30	36	8	–	5	0.023
36 T5/12-2	35.03	12	6F	Al	19.25	18.25	23.0	30	36	11	–	6	0.031
36 T5/14-2	35.70	14	6F	Al	22.45	21.45	25.0	30	36	14	–	8	0.037
36 T5/15-2	37.05	15	6F	Al	24.05	23.05	28.0	30	36	16	6	10	0.041
36 T5/16-2	39.29	16	6F	Al	25.60	24.60	32.0	30	36	18	6	11	0.050
36 T5/18-2	40.53	18	6F	Al	28.80	27.80	32.0	30	36	20	6	12	0.061
36 T5/19-2	41.76	19	6F	Al	30.40	29.40	36.0	30	36	22	6	12	0.070
36 T5/20-2	43.66	20	6F	Al	32.00	31.00	36.0	30	36	24	6	14	0.076
36 T5/22-2	47.73	22	6F	Al	35.25	34.25	38.0	30	36	24	6	15	0.080
36 T5/24-2	50.28	24	6F	Al	38.40	37.40	42.0	30	36	26	6	15	0.109
36 T5/25-2	52.76	25	6F	Al	40.00	39.00	44.0	30	36	26	8	15	0.116
36 T5/26-2	53.02	26	6F	Al	41.60	40.60	44.0	30	36	26	8	16	0.120
36 T5/27-2	53.31	27	6F	Al	43.20	42.20	48.0	30	36	30	8	18	0.128
36 T5/28-2	53.76	28	6F	Al	44.75	43.75	48.0	30	36	32	8	18	0.128
36 T5/30-2	54.22	30	6F	Al	47.95	46.95	51.0	30	36	34	8	18	0.150
36 T5/32-2	55.89	32	6F	Al	51.10	50.10	54.0	30	36	38	8	22	0.176
36 T5/36-2	62.06	36	6F	Al	57.45	56.45	63.0	30	36	38	8	22	0.230
36 T5/40-2	68.80	40	6F	Al	63.85	62.85	66.0	30	36	40	8	23	0.276
36 T5/42-2	76.29	42	6F	Al	67.00	66.00	71.0	30	36	40	8	24	0.284
36 T5/44-0	81.32	44	6	Al	70.20	69.20	–	30	36	45	8	26	0.315
36 T5/48-0	85.52	48	6	Al	76.55	75.55	–	30	36	50	8	28	0.400
36 T5/60-0	101.23	60	6	Al	95.65	94.65	–	30	36	65	8	35	0.614

Al = ALUMINUM

4 METRIC TIMING PULLEY & BAR STOCK

T10 Pitch– For Belt Width 16mm Metric Timing Belt Pulleys

Part Number	List Price	Number of Teeth	Pulley Type	Material	d _w (mm)	d _a (mm)	d _B (mm)	b ₁ (mm)	B (mm)	D (mm)	Pilot bore d (mm)	Finished bore d _{max} (mm)	Weight Kg
31 T10/12-2	34.93	12	6F	Al	38.35	36.35	42	21	31	28	6	16	0.076
31 T10/14-2	41.91	14	6F	Al	44.70	42.70	48	21	31	32	8	18	0.104
31 T10/15-2	44.45	15	6F	Al	47.90	45.90	51	21	31	32	8	18	0.116
31 T10/16-2	47.63	16	6F	Al	51.05	49.05	54	21	31	35	8	20	0.134
31 T10/18-2	50.80	18	6F	Al	57.45	55.45	60	21	31	40	8	22	0.167
31 T10/19-2	54.61	19	6F	Al	60.60	58.60	66	21	31	44	8	22	0.184
31 T10/20-2	55.88	20	6F	Al	63.80	61.80	66	21	31	46	8	24	0.208
31 T10/22-2	64.21	22	6F	Al	70.15	68.15	75	21	31	52	8	28	0.253
31 T10/24-2	66.04	24	6F	Al	76.55	74.55	83	21	31	58	8	30	0.288
31 T10/25-2	68.80	25	6F	Al	79.70	77.70	83	21	31	60	8	30	0.310
31 T10/26-2	73.20	26	6F	Al	82.90	80.90	87	21	31	60	8	30	0.357
31 T10/27-2	76.10	27	6F	Al	86.10	84.10	91	21	31	60	8	30	0.364
31 T10/28-2	79.72	28	6F	Al	89.25	87.25	93	21	31	60	8	30	0.401
31 T10/30-2	84.46	30	6F	Al	95.65	93.65	97	21	31	60	10	30	0.441
31 T10/32-2	102.87	32	6F	Al	102.00	100.00	106	21	31	65	10	32	0.493
31 T10/36-2	113.46	36	6F	Al	114.75	112.75	119	21	31	70	10	35	0.623
31 T10/40-2	132.08	40	6F	Al	127.45	125.45	131	21	31	80	10	40	0.767
31 T10/44-0	144.89	44	6	Al	140.20	138.20	–	21	31	88	10	46	0.993
31 T10/48-0	167.01	48	6	Al	152.95	150.95	–	21	31	95	16	48	1.090
31 T10/60-0	231.78	60	6	Al	191.10	189.10	–	21	31	110	16	60	1.701

T10 Pitch– For Belt Width 25mm Metric Timing Belt Pulleys

40 T10/12-2	38.10	12	6F	Al	38.35	36.35	42	30	40	28	6	16	0.099
40 T10/14-2	46.36	14	6F	Al	44.70	42.70	48	30	40	32	8	18	0.134
40 T10/15-2	50.80	15	6F	Al	47.90	45.90	51	30	40	32	8	18	0.152
40 T10/16-2	53.98	16	6F	Al	51.05	49.05	54	30	40	35	8	20	0.176
40 T10/18-2	57.79	18	6F	Al	57.45	55.45	60	30	40	40	8	22	0.224
40 T10/19-2	62.23	19	6F	Al	60.60	58.60	66	30	40	44	8	22	0.247
40 T10/20-2	63.50	20	6F	Al	63.80	61.80	66	30	40	46	8	24	0.276
40 T10/22-2	74.22	22	6F	Al	70.15	68.15	75	30	40	52	8	28	0.337
40 T10/24-2	77.33	24	6F	Al	76.55	74.55	83	30	40	58	8	30	0.392
40 T10/25-2	79.91	25	6F	Al	79.70	77.70	83	30	40	60	8	30	0.422
40 T10/26-2	82.99	26	6F	Al	82.90	80.90	87	30	40	60	8	30	0.477
40 T10/27-2	85.73	27	6F	Al	86.10	84.10	91	30	40	60	8	30	0.536
40 T10/28-2	90.08	28	6F	Al	89.25	87.25	93	30	40	60	8	30	0.540
40 T10/30-2	97.79	30	6F	Al	95.65	93.65	97	30	40	60	8	30	0.640
40 T10/32-2	120.02	32	6F	Al	102.00	100.00	106	30	40	65	10	32	0.693
40 T10/36-2	130.18	36	6F	Al	114.75	112.75	119	30	40	70	10	35	0.873
40 T10/40-2	154.94	40	6F	Al	127.45	125.45	131	30	40	80	10	40	1.067
40 T10/44-0	173.93	44	6	Al	140.20	138.20	–	30	40	88	10	46	1.350
40 T10/48-0	202.56	48	6	Al	152.95	150.95	–	30	40	95	16	48	1.516
40 T10/60-0	284.48	60	6	Al	191.10	189.10	–	30	40	110	16	60	2.339

Al = Aluminum

T10 Pitch– For Belt Width 32mm**Metric Timing Belt Pulleys**

Part Number	List Price	Number of Teeth	Pulley Type	Material	d _w (mm)	d _a (mm)	d _B (mm)	b ₁ (mm)	B (mm)	D (mm)	Pilot bore d (mm)	Finished bore d _{max} (mm)	Weight Kg
47 T10/18-2	75.40	18	6F	Al	57.45	55.45	66	37	47	40	10	22	0.253
47 T10/19-2	83.57	19	6F	Al	60.60	58.60	66	37	47	44	10	22	0.286
47 T10/20-2	87.41	20	6F	Al	63.80	61.80	66	37	47	46	12	24	0.322
47 T10/22-2	95.48	22	6F	Al	70.15	68.15	75	37	47	52	12	28	0.393
47 T10/24-2	99.81	24	6F	Al	76.55	74.55	83	37	47	58	12	30	0.475
47 T10/25-2	106.90	25	6F	Al	79.70	77.70	83	37	47	60	12	30	0.527
47 T10/26-2	115.76	26	6F	Al	82.90	80.90	87	37	47	60	12	30	0.564
47 T10/27-2	121.27	27	6F	Al	86.10	84.10	91	37	47	60	12	30	0.602
47 T10/28-2	128.96	28	6F	Al	89.25	87.25	93	37	47	60	12	30	0.642
47 T10/30-2	133.08	30	6F	Al	95.65	93.65	97	37	47	60	12	30	0.740
47 T10/32-2	160.25	32	6F	Al	102.00	100.00	106	37	47	65	12	32	0.844
47 T10/36-2	175.22	36	6F	Al	114.75	112.75	119	37	47	70	16	35	1.083
47 T10/40-2	201.00	40	6F	Al	127.45	125.45	131	37	47	80	16	40	1.317
47 T10/44-0	242.75	44	6	Al	140.20	138.20	–	37	47	88	16	46	1.611
47 T10/48-0	263.80	48	6	Al	152.95	150.95	–	37	47	95	16	48	1.931
47 T10/60-0	363.82	60	6	Al	191.10	189.10	–	37	47	110	16	110	3.004

T10 Pitch– For Belt Width 50mm**Metric Timing Belt Pulleys**

66 T10/18-2	76.77	18	6F	Al	57.45	55.45	60	56	66	40	10	22	0.422
66 T10/19-2	88.33	19	6F	Al	60.60	58.60	66	56	66	44	10	22	0.466
66 T10/20-2	92.71	20	6F	Al	63.80	61.80	66	56	66	46	12	24	0.520
66 T10/22-2	95.19	22	6F	Al	70.15	68.15	75	56	66	52	12	28	0.570
66 T10/24-2	99.26	24	6F	Al	76.55	74.55	83	56	66	58	12	30	0.736
66 T10/25-2	105.60	25	6F	Al	79.70	77.70	83	56	66	60	12	30	0.766
66 T10/26-2	119.02	26	6F	Al	82.90	80.90	87	56	66	60	12	30	0.816
66 T10/27-2	126.92	27	6F	Al	86.10	84.10	91	56	66	60	12	30	0.946
66 T10/28-2	134.16	28	6F	Al	89.25	87.25	93	56	66	60	12	30	0.960
66 T10/30-2	139.23	30	6F	Al	95.65	93.65	97	56	66	60	12	30	1.169
66 T10/32-2	168.55	32	6F	Al	102.00	100.00	106	56	66	65	12	32	1.300
66 T10/36-2	182.47	36	6F	Al	114.75	112.75	119	56	66	70	16	35	1.637
66 T10/40-2	218.44	40	6F	Al	127.45	125.45	131	56	66	80	16	40	1.999
66 T10/44-0	256.18	44	6	Al	140.20	138.20	–	56	66	88	16	46	2.357
66 T10/48-0	291.47	48	6	Al	152.95	150.95	–	56	66	95	16	48	2.830
66 T10/60-0	424.82	60	6	Al	191.10	189.10	–	56	66	110	16	60	4.366

Al = Aluminum

AT5 Pitch– For Belt Width 10 mm

Metric Timing Belt Pulleys

Part Number	List Price	Number of Teeth	Pulley Type	Material	d _w (mm)	d _a (mm)	d _B (mm)	b ₁ (mm)	B (mm)	D (mm)	Pilot bore d (mm)	Finished bore d _{max} (mm)	Weight Kg
21AT5/12-2	50.32	12	6F	Al	18.85	17.85	23	15	21	11	0	6	0.016
21AT5/14-2	52.00	14	6F	Al	22.05	21.05	25	15	21	14	0	8	0.019
21AT5/15-2	53.45	15	6F	Al	23.65	22.65	28	15	21	16	6	10	0.021
21AT5/16-2	57.00	16	6F	Al	25.20	24.20	32	15	21	18	6	11	0.025
21AT5/18-2	63.27	18	6F	Al	28.40	27.40	32	15	21	20	6	12	0.031
21AT5/19-2	64.59	19	6F	Al	30.00	29.00	36	15	21	22	6	12	0.036
21AT5/20-2	66.73	20	6F	Al	31.60	30.60	36	15	21	23	6	14	0.038
21AT5/22-2	69.09	22	6F	Al	34.85	33.85	38	15	21	24	6	15	0.046
21AT5/24-2	69.27	24	6F	Al	38.00	37.00	42	15	21	26	6	15	0.054
21AT5/25-2	70.27	25	6F	Al	39.60	38.60	44	15	21	26	6	15	0.058
21AT5/26-2	71.73	26	6F	Al	41.20	40.20	44	15	21	26	6	15	0.062
21AT5/27-2	72.18	27	6F	Al	42.80	41.80	48	15	21	30	8	18	0.064
21AT5/28-2	73.05	28	6F	Al	44.35	43.35	48	15	21	32	8	18	0.071
21AT5/30-2	74.95	30	6F	Al	47.55	46.55	51	15	21	34	8	18	0.075
21AT5/32-2	84.86	32	6F	Al	50.70	49.70	54	15	21	38	8	22	0.088
21AT5/36-2	90.77	36	6F	Al	57.05	56.05	63	15	21	38	8	22	0.114
21AT5/40-2	104.36	40	6F	Al	63.45	62.45	66	15	21	40	8	23	0.138
21AT5/42-2	107.45	42	6F	Al	66.60	65.60	71	15	21	40	8	24	0.180
21AT5/44-0	110.14	44	6	Al	69.80	68.80	-	15	21	45	8	26	0.185
21AT5/48-0	130.50	48	6	Al	76.15	75.15	-	15	21	50	8	28	0.200
21AT5/60-0	149.45	60	6	Al	95.25	94.25	-	15	21	65	8	35	0.307

AT5 Pitch – For Belt Width 16 mm

Metric Timing Belt Pulleys

Part Number	List Price	Number of Teeth	Pulley Type	Material	d _w (mm)	d _a (mm)	d _B (mm)	b ₁ (mm)	B (mm)	D (mm)	Pilot bore d (mm)	Finished bore d _{max} (mm)	Weight Kg
27AT5/12-2	53.23	12	6F	Al	18.85	17.85	23	21	27	11	0	6	0.022
27AT5/14-2	55.23	14	6F	Al	22.05	21.05	25	21	27	14	0	8	0.026
27AT5/15-2	56.23	15	6F	Al	23.65	22.65	28	21	27	16	6	10	0.029
27AT5/16-2	61.91	16	6F	Al	25.20	24.20	32	21	27	18	6	11	0.035
27AT5/18-2	64.36	18	6F	Al	28.40	27.40	32	21	27	20	6	12	0.043
27AT5/19-2	66.91	19	6F	Al	30.00	29.00	36	21	27	22	6	12	0.049
27AT5/20-2	68.59	20	6F	Al	31.60	30.60	36	21	27	23	6	14	0.053
27AT5/22-2	73.41	22	6F	Al	34.85	33.85	38	21	27	24	6	15	0.054
27AT5/24-2	76.86	24	6F	Al	38.00	37.00	42	21	27	26	6	15	0.076
27AT5/25-2	77.73	25	6F	Al	39.60	38.60	44	21	27	26	6	15	0.081
27AT5/26-2	80.64	26	6F	Al	41.20	40.20	44	21	27	26	6	15	0.085
27AT5/27-2	82.73	27	6F	Al	42.80	41.80	48	21	27	30	8	18	0.090
27AT5/28-2	83.41	28	6F	Al	44.35	43.35	48	21	27	32	8	18	0.092
27AT5/30-2	84.09	30	6F	Al	47.55	46.55	51	21	27	34	8	18	0.105
27AT5/32-2	98.45	32	6F	Al	50.70	49.70	54	21	27	38	8	22	0.123
27AT5/36-2	108.45	36	6F	Al	57.05	56.05	63	21	27	38	8	22	0.160
27AT5/40-2	123.18	40	6F	Al	63.45	62.45	66	21	27	40	8	23	0.193
27AT5/42-2	129.64	42	6F	Al	66.60	65.60	71	21	27	40	8	24	0.205
27AT5/44-0	130.95	44	6	Al	69.80	68.80	-	21	27	45	8	26	0.228
27AT5/48-0	142.09	48	6	Al	76.15	75.15	-	21	27	50	8	28	0.280
27AT5/60-0	170.59	60	6	Al	95.25	94.25	-	21	27	65	8	35	0.430

Al = Aluminum

AT5 Pitch– For Belt Width 25mm

Metric Timing Belt Pulleys

Part Number	List Price	Number of Teeth	Pulley Type	Material	d _w (mm)	d _a (mm)	d _B (mm)	b ₁ (mm)	B (mm)	D (mm)	Pilot bore d (mm)	Finished bore d _{max} (mm)	Weight Kg
36AT5/12-2	69.59	12	6F	Al	18.85	17.85	23	30	36	11	0	6	0.031
36AT5/14-2	71.05	14	6F	Al	22.05	21.05	25	30	36	14	0	8	0.037
36AT5/15-2	71.50	15	6F	Al	23.65	22.65	28	30	36	16	6	10	0.041
36AT5/16-2	73.05	16	6F	Al	25.20	24.20	32	30	36	18	6	11	0.050
36AT5/18-2	74.95	18	6F	Al	28.40	27.40	32	30	36	20	6	12	0.061
36AT5/19-2	76.64	19	6F	Al	30.00	29.00	36	30	36	22	6	12	0.070
36AT5/20-2	77.77	20	6F	Al	31.60	30.60	36	30	36	23	6	14	0.076
36AT5/22-2	82.73	22	6F	Al	34.85	33.85	38	30	36	24	6	15	0.080
36AT5/24-2	85.32	24	6F	Al	38.00	37.00	42	30	36	26	8	15	0.109
36AT5/25-2	88.18	25	6F	Al	39.60	38.60	44	30	36	26	8	15	0.116
36AT5/26-2	89.09	26	6F	Al	41.20	40.20	44	30	36	26	8	15	0.120
36AT5/27-2	90.23	27	6F	Al	42.80	41.80	48	30	36	30	8	18	0.128
36AT5/28-2	91.77	28	6F	Al	44.35	43.35	48	30	36	32	8	18	0.135
36AT5/30-2	94.09	30	6F	Al	47.55	46.55	51	30	36	34	8	18	0.150
36AT5/32-2	108.23	32	6F	Al	50.70	49.70	54	30	36	38	8	22	0.176
36AT5/36-2	117.14	36	6F	Al	57.05	56.05	53	30	36	38	8	22	0.230
36AT5/40-2	132.55	40	6F	Al	63.45	62.45	66	30	36	40	8	23	0.276
36AT5/42-2	139.86	42	6F	Al	66.60	65.60	71	30	36	40	8	24	0.284
36AT5/44-0	140.77	44	6	Al	69.80	68.80	-	30	36	45	8	26	0.315
36AT5/48-0	161.27	48	6	Al	76.15	75.15	-	30	36	50	8	28	0.400
36AT5/60-0	195.32	60	6	Al	95.25	94.25	-	30	36	65	8	35	0.614

Al = Aluminum

4 METRIC TIMING PULLEY & BAR STOCK

AT10 Pitch– For Belt Width 16mm

Metric Timing Belt Pulleys

Part Number	List Price	Number of Teeth	Pulley Type	Material	d _w (mm)	d _a (mm)	d _B (mm)	b ₁ (mm)	B (mm)	D (mm)	Pilot bore d (mm)	Finished bore d _{max} (mm)	Weight Kg
31AT10/15-2	76.86	15	6F	Al	47.90	45.90	51	21	31	32	8	18	0.116
31AT10/16-2	83.95	16	6F	Al	51.05	49.05	54	21	31	35	8	20	0.134
31AT10/18-2	97.55	18	6F	Al	57.45	55.45	60	21	31	40	8	22	0.167
31AT10/19-2	103.77	19	6F	Al	60.60	58.60	66	21	31	44	8	22	0.184
31AT10/20-2	108.45	20	6F	Al	63.80	61.80	66	21	31	46	8	24	0.208
31AT10/22-2	114.05	22	6F	Al	70.15	68.15	75	21	31	52	8	28	0.253
31AT10/24-2	128.50	24	6F	Al	76.55	74.55	83	21	31	58	8	30	0.288
31AT10/25-2	133.64	25	6F	Al	79.70	77.70	83	21	31	60	8	30	0.310
31AT10/26-2	139.86	26	6F	Al	82.90	80.90	87	21	31	60	8	30	0.357
31AT10/27-2	150.77	27	6F	Al	86.10	84.10	91	21	31	60	8	30	0.364
31AT10/28-2	157.91	28	6F	Al	89.25	87.25	93	21	31	60	8	30	0.401
31AT10/30-2	171.05	30	6F	Al	95.65	93.65	97	21	31	60	8	30	0.441
31AT10/32-2	200.23	32	6F	Al	102.00	100.00	106	21	31	65	10	32	0.493
31AT10/36-2	228.32	36	6F	Al	114.75	112.75	119	21	31	70	10	35	0.623
31AT10/40-2	272.86	40	6F	Al	127.45	125.45	131	21	31	80	10	40	0.767
31AT10/44-0	300.91	44	6	Al	140.20	138.20	-	21	31	88	10	46	0.993
31AT10/48-0	368.64	48	6	Al	152.95	150.95	-	21	31	95	10	48	1.090
31AT10/60-0	524.55	60	6	Al	191.10	189.10	-	21	31	110	10	60	1.701

AT10 Pitch– For Belt Width 25mm

Metric Timing Belt Pulleys

Part Number	List Price	Number of Teeth	Pulley Type	Material	d _w (mm)	d _a (mm)	d _B (mm)	b ₁ (mm)	B (mm)	D (mm)	Pilot bore d (mm)	Finished bore d _{max} (mm)	Weight Kg
40AT10/15-2	91.77	15	6F	Al	47.90	45.90	51	30	40	32	8	18	0.152
40AT10/16-2	98.77	16	6F	Al	51.05	49.05	54	30	40	35	8	20	0.176
40AT10/18-2	107.45	18	6F	Al	57.45	55.45	60	30	40	40	8	22	0.224
40AT10/19-2	113.59	19	6F	Al	60.60	58.60	66	30	40	44	8	22	0.247
40AT10/20-2	128.50	20	6F	Al	63.80	61.80	66	30	40	46	8	24	0.276
40AT10/22-2	135.18	22	6F	Al	70.15	68.15	75	30	40	52	8	28	0.337
40AT10/24-2	146.09	24	6F	Al	76.55	74.55	83	30	40	58	8	30	0.392
40AT10/25-2	154.59	25	6F	Al	79.70	77.70	83	30	40	60	8	30	0.422
40AT10/26-2	163.27	26	6F	Al	82.90	80.90	87	30	40	60	8	30	0.477
40AT10/27-2	173.95	27	6F	Al	86.10	84.10	91	30	40	60	8	30	0.536
40AT10/28-2	179.95	28	6F	Al	89.25	87.25	93	30	40	60	8	30	0.540
40AT10/30-2	196.23	30	6F	Al	95.65	93.65	97	30	40	60	8	30	0.640
40AT10/32-2	226.27	32	6F	Al	102.00	100.00	106	30	40	65	10	32	0.693
40AT10/36-2	264.82	36	6F	Al	114.75	112.75	119	30	40	70	10	35	0.873
40AT10/40-2	325.64	40	6F	Al	127.45	125.45	131	30	40	80	10	40	1.067
40AT10/44-0	355.45	44	6	Al	140.20	138.20	-	30	40	88	10	46	1.350
40AT10/48-0	430.55	48	6	Al	152.95	150.95	-	30	40	95	10	48	1.516
40AT10/60-0	657.05	60	6	Al	191.10	189.10	-	30	40	110	10	60	2.339

Al = Aluminum

AT10 Pitch– For Belt Width 32mm Metric Timing Belt Pulleys

Part Number	List Price	Number of Teeth	Pulley Type	Material	d _w (mm)	d _a (mm)	d _B (mm)	b ₁ (mm)	B (mm)	D (mm)	Pilot bore d (mm)	Finished bore d _{max} (mm)	Weight Kg
47AT10/18-2	133.18	18	6F	Al	57.45	55.45	60	37	47	40	22		0.253
47AT10/19-2	142.77	19	6F	Al	60.60	58.60	66	37	47	44	22		0.286
47AT10/20-2	152.77	20	6F	Al	63.80	61.80	66	37	47	46	24		0.322
47AT10/22-2	167.05	22	6F	Al	70.15	68.15	75	37	47	52	28		0.393
47AT10/24-2	173.95	24	6F	Al	76.55	74.55	83	37	47	58	30		0.475
47AT10/25-2	186.64	25	6F	Al	79.70	77.70	83	37	47	60	30		0.527
47AT10/26-2	199.36	26	6F	Al	82.90	80.90	87	37	47	60	30		0.564
47AT10/27-2	207.59	27	6F	Al	86.10	84.10	91	37	47	60	30		0.602
47AT10/28-2	212.05	28	6F	Al	89.25	87.25	93	37	47	60	30		0.642
47AT10/30-2	238.09	30	6F	Al	95.65	93.65	97	37	47	60	30		0.740
47AT10/32-2	267.05	32	6F	Al	102.00	100.00	106	37	47	65	32		0.844
47AT10/36-2	319.41	36	6F	Al	114.75	112.75	119	37	47	70	35		1.063
47AT10/40-2	384.64	40	6F	Al	127.45	125.45	131	37	47	80	40		1.317
47AT10/44-0	422.50	44	6	Al	140.20	138.20	-	37	47	88	46		1.611
47AT10/48-0	507.82	48	6	Al	152.95	150.95	-	37	47	95	48		1.931
47AT10/60-0	763.95	60	6	Al	191.10	189.10	-	37	47	110	60		3.004

AT10 Pitch– For Belt Width 50mm Metric Timing Belt Pulleys

66AT10/18-2	152.77	18	6F	Al	57.45	55.45	60	56	66	40	10	22	0.422
66AT10/19-2	164.14	19	6F	Al	60.60	58.60	66	56	66	44	10	22	0.466
66AT10/20-2	175.05	20	6F	Al	63.80	61.80	66	56	66	46	12	24	0.520
66AT10/22-2	193.55	22	6F	Al	70.15	68.15	75	56	66	52	12	28	0.570
66AT10/24-2	212.50	24	6F	Al	76.55	74.55	83	56	66	58	12	30	0.736
66AT10/25-2	229.86	25	6F	Al	79.70	77.70	83	56	66	60	12	30	0.766
66AT10/26-2	238.32	26	6F	Al	82.90	80.90	87	56	66	60	12	30	0.816
66AT10/27-2	247.00	27	6F	Al	86.10	84.10	91	56	66	60	12	30	0.946
66AT10/28-2	255.45	28	6F	Al	89.25	87.25	93	56	66	60	12	30	0.960
66AT10/30-2	287.55	30	6F	Al	95.65	93.65	97	56	66	60	12	30	1.169
66AT10/32-2	317.82	32	6F	Al	102.00	100.00	106	56	66	65	12	32	1.300
66AT10/36-2	403.36	36	6F	Al	114.75	112.75	119	56	66	70	16	35	1.637
66AT10/40-2	458.82	40	6F	Al	127.45	125.45	131	56	66	80	16	40	1.999
66AT10/44-0	543.45	44	6	Al	140.20	138.20	-	56	66	88	16	46	2.357
66AT10/48-0	621.41	48	6	Al	152.95	150.95	-	56	66	95	16	48	2.830
66AT10/60-0	1007.86	60	6	Al	191.10	189.10	-	56	66	110	16	60	4.366

Al = Aluminum

T5 & T10 Pitch

Metric Pulley Stock

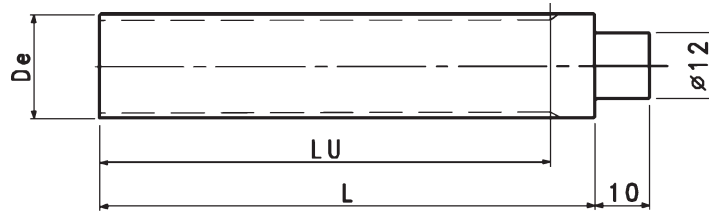

T5 Aluminum Pulley Stock

T10 Aluminum Pulley Stock

PART #	LIST PRICE	# OF TEETH	De (mm)	Lu (mm)	L (mm)	PART #	LIST PRICE	# OF TEETH	De (mm)	Lu (mm)	L (mm)
T5-10	62.82	10	15.05	125	140	T10-10	80.50	10	29.98	140	140
T5-11	63.68	11	16.65	125	140	T10-11	89.09	11	33.16	140	140
T5-12	66.05	12	18.25	125	140	T10-12	103.14	12	36.35	140	140
T5-13	73.82	13	19.85	125	140	T10-13	112.05	13	39.50	140	140
T5-14	79.27	14	21.45	132	140	T10-14	135.18	14	42.70	160	160
T5-15	79.64	15	23.05	132	140	T10-15	154.14	15	45.90	160	160
T5-16	88.32	16	24.60	140	140	T10-16	174.64	16	49.05	160	160
T5-17	88.64	17	26.20	140	140	T10-17	177.27	17	52.25	160	160
T5-18	93.23	18	27.80	140	140	T10-18	197.77	18	55.45	160	160
T5-19	96.45	19	29.40	140	140	T10-19	203.59	19	58.60	160	160
T5-20	108.59	20	31.00	160	160	T10-20	223.64	20	61.60	160	160
T5-21	116.95	21	32.70	160	160	T10-21	250.77	21	65.00	160	160
T5-22	135.41	22	34.25	160	160	T10-22	255.45	22	68.15	160	160
T5-23	136.32	23	35.85	160	160	T10-23	284.64	23	71.35	160	160
T5-24	140.77	24	37.40	160	160	T10-24	314.73	24	74.55	160	160
T5-25	141.86	25	39.00	160	160	T10-26	344.55	26	80.90	160	160
T5-26	154.59	26	40.60	160	160	T10-28	383.32	28	87.25	160	160
T5-27	165.73	27	42.20	160	160	T10-30	426.32	30	96.65	160	160
T5-28	167.27	28	43.75	160	160	T10-32	561.27	32	100.00	160	160
T5-29	182.64	29	45.35	160	160	T10-34	591.36	34	106.40	160	160
T5-30	188.23	30	46.95	160	160	T10-36	654.82	36	112.75	160	160
T5-32	204.45	32	50.10	160	160	T10-38	765.09	38	119.10	160	160
T5-34	208.45	34	53.25	160	160	T10-40	818.55	40	125.45	160	160
T5-35	233.64	35	54.85	160	160	T10-45	1042.36	45	141.40	160	160
T5-36	241.45	36	56.45	160	160	T10-48	1153.73	48	150.95	160	160
T5-37	250.77	37	58.06	160	160	T10-60	1768.45	60	189.10	160	160
T5-38	262.36	38	59.65	160	160						
T5-40	266.18	40	62.85	160	160						
T5-42	287.77	42	66.00	160	160						
T5-44	311.82	44	69.20	160	160						
T5-45	317.59	45	70.80	160	160						
T5-46	322.95	46	72.40	160	160						
T5-48	347.23	48	75.55	160	160						
T5-50	361.50	50	78.75	160	160						
T5-60	496.68	60	94.65	160	160						
T5-72	663.73	72	113.75	160	160						
T5-80	795.14	80	126.48	160	160						
T5-90	949.95	90	142.40	160	160						
T5-100	1051.27	100	158.31	160	160						

AT5 & AT10 Pitch

Metric Pulley Stock

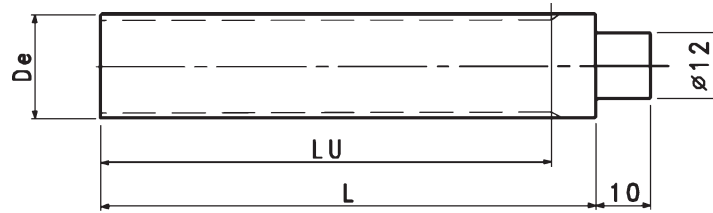

AT5 Aluminum Pulley Stock

AT10 Aluminum Pulley Stock

PART #	LIST PRICE	# OF TEETH	De (mm)	Lu (mm)	L (mm)	PART #	LIST PRICE	# OF TEETH	De (mm)	Lu (mm)	L (mm)
AT5-12	79.27	12	17.85	125	140	AT10-15	184.86	15	45.90	160	160
AT5-13	88.64	13	19.45	125	140	AT10-16	195.95	16	49.05	160	160
AT5-14	95.09	14	21.05	132	140	AT10-17	212.73	17	52.25	160	160
AT5-15	95.55	15	22.65	132	140	AT10-18	237.41	18	55.45	160	160
AT5-16	106.00	16	24.20	140	140	AT10-19	244.32	19	58.60	160	160
AT5-17	106.36	17	25.80	140	140	AT10-20	268.41	20	61.80	160	160
AT5-18	111.82	18	27.40	140	140	AT10-21	300.91	21	65.00	160	160
AT5-19	115.82	19	29.00	140	140	AT10-22	306.45	22	68.15	160	160
AT5-20	130.32	20	30.60	160	160	AT10-23	341.68	23	71.35	160	160
AT5-21	140.32	21	32.30	160	160	AT10-24	377.73	24	74.55	160	160
AT5-22	162.59	22	33.85	160	160	AT10-25	402.68	25	77.70	160	160
AT5-23	163.50	23	35.45	160	160	AT10-26	413.36	26	80.90	160	160
AT5-24	168.82	24	37.00	160	160	AT10-27	451.05	27	84.10	160	160
AT5-25	170.18	25	38.60	160	160	AT10-28	459.95	28	87.25	160	160
AT5-26	185.55	26	40.20	160	160	AT10-29	490.00	29	90.45	160	160
AT5-27	198.91	27	41.80	160	160	AT10-30	511.18	30	93.65	160	160
AT5-28	200.68	28	43.35	160	160	AT10-31	599.14	31	96.80	160	160
AT5-29	219.18	29	44.95	160	160	AT10-32	673.77	32	100.00	160	160
AT5-30	225.86	30	46.55	160	160	AT10-33	696.05	33	103.20	160	160
AT5-31	238.77	31	48.15	160	160	AT10-34	709.41	34	106.40	160	160
AT5-32	245.45	32	49.70	160	160	AT10-35	756.18	35	109.55	160	160
AT5-33	248.36	33	51.30	160	160	AT10-36	786.23	36	112.75	160	160
AT5-34	250.14	34	52.85	160	160	AT10-37	866.41	37	115.90	160	160
AT5-35	280.41	35	54.45	160	160	AT10-38	917.64	38	119.10	160	160
AT5-36	289.77	36	56.05	160	160	AT10-40	982.23	40	125.45	160	160
AT5-38	314.95	38	59.25	160	160	AT10-41	1079.14	41	128.65	160	160
AT5-40	319.41	40	62.45	160	160	AT10-42	1128.14	42	131.85	160	160
AT5-42	345.23	42	65.60	160	160	AT10-44	1223.91	44	138.20	160	160
AT5-44	374.18	44	68.80	160	160	AT10-45	1250.64	45	141.40	160	160
AT5-45	380.86	45	70.40	160	160	AT10-46	1321.91	46	144.55	160	160
AT5-46	387.55	46	72.00	160	160	AT10-48	1384.27	48	150.95	160	160
AT5-48	416.73	48	75.15	160	160	AT10-50	1551.32	50	157.30	160	160
AT5-50	433.86	50	78.35	160	160	AT10-51	1617.00	51	160.50	160	160
AT5-52	459.95	52	81.55	160	160	AT10-52	1674.91	52	163.65	160	160
AT5-54	494.45	54	84.70	160	160	AT10-54	1806.32	54	170.05	160	160
AT5-55	505.59	55	86.30	160	160	AT10-55	1859.77	55	173.20	160	160
AT5-56	543.45	56	87.90	160	160	AT10-56	1915.45	56	176.40	160	160
AT5-58	574.64	58	91.10	160	160	AT10-57	1982.27	57	179.60	160	160
AT5-60	595.82	60	94.25	160	160	AT10-58	2032.41	58	182.75	160	160
AT5-62	633.68	62	97.45	160	160	AT10-59	2089.18	59	185.95	160	160
AT5-64	667.09	64	100.65	160	160	AT10-60	2122.59	60	189.10	160	160
AT5-65	688.23	65	102.25	160	160	AT10-62	2192.77	62	195.50	160	160
AT5-70	771.77	70	110.20	160	160	AT10-70	2717.27	70	220.95	160	160
AT5-72	796.27	72	113.35	160	160	AT10-75	3103.73	75	236.90	160	160

