

Stainless Steel *jaw*

Amazingly Affordable. Unsurpassed Quality.

Lovejoy's Jaw Coupling Now Standard In Stainless Steel.

In applications that require the use of stainless steel components, Lovejoy's SS-type jaw coupling offers a new level of affordability and availability.

- Hubs with finished bores are passivated against rust
- Immediate delivery available in 5 sizes – either rough bore or finished bore and keyway combinations
- Select from bore sizes $\frac{1}{4}$ "(SS075) to $1\text{-}\frac{7}{8}$ "(SS150)
- Interchangeable with all hub sizes standard for the L-line and AL-line products
- Hubs can be used with inserts in 4 different materials: Buna-N (Sox), Urethane, Hytrel and Bronze
- Use with Lovejoy's Jaw-in-Shear to create a completely stainless steel in-shear coupling

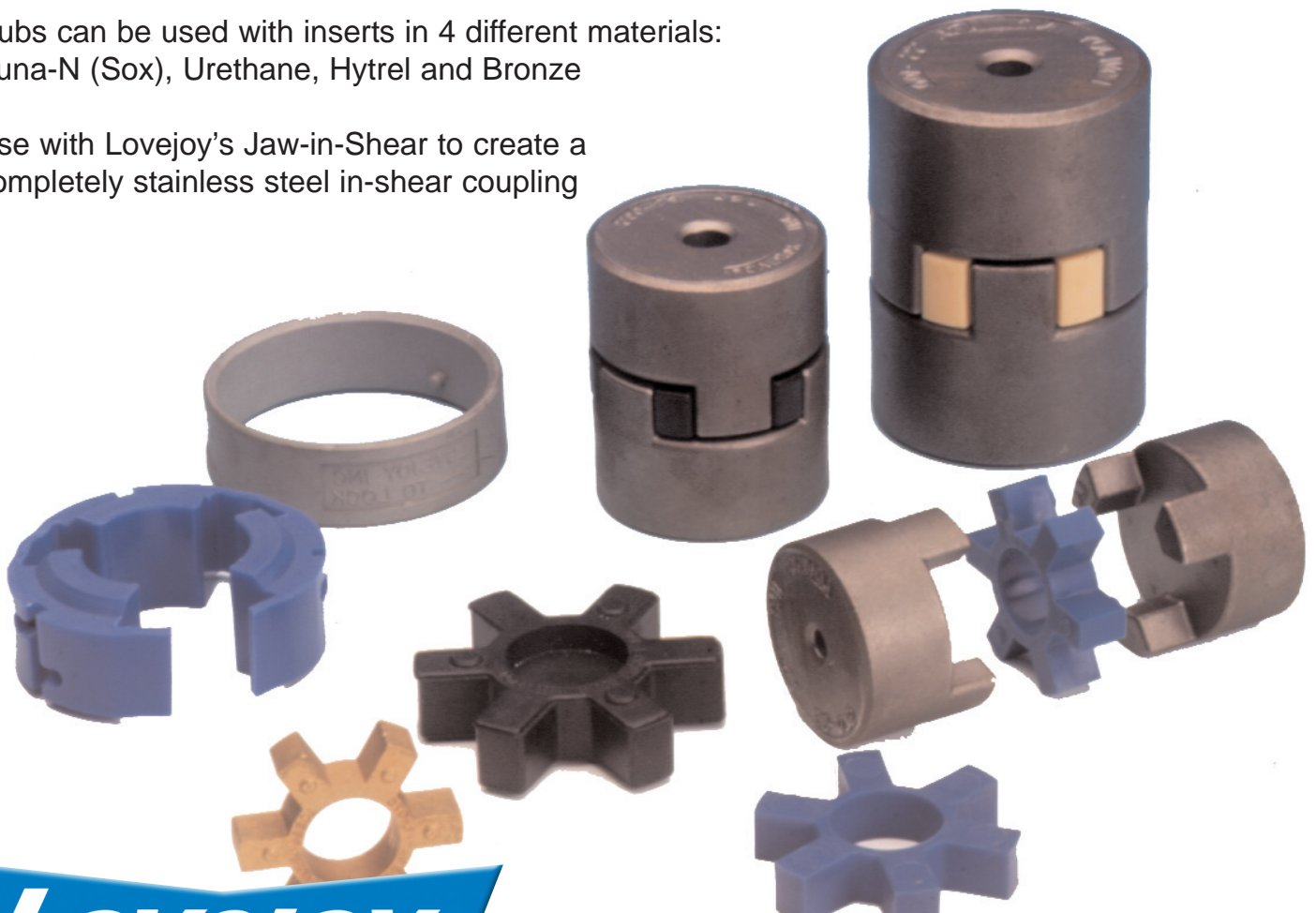

Lovejoy[®]

WHERE THE WORLD TURNS FOR COUPLINGS.

For more information on the Lovejoy Stainless Steel Jaw coupling contact us at (630) 852-0500 or visit our web site:

www.lovejoy-inc.com

Stainless Steel *Jaw*

Stainless Steel Coupling Dimensional Data-Inch – Chart 1

Size	Max Bore in mm	Outside Diameter OD	Overall Length OAL	Gap G	Length Thru Bore LTB	Hub Diameter	Set Screw Location SL	Set Screw Size T
SS075	0.875 22	1.75	2.13	0.50	0.82	1.75	0.31	1/4-20
SS095	1.125 28	2.11	2.51	0.52	1.00	2.11	0.44	5/16-18
SS100	1.375 35	2.54	3.48	0.71	1.38	2.54	0.44	5/16-18
SS110	1.625 42	3.32	4.22	0.88	1.68	3.32	0.75	3/8-16
SS150	1.875 48	3.75	4.50	1.00	1.75	3.75	0.75	3/8-16

SIMILAR IN SIZE
TO BROWNING
JS4 COUPLING

SIMILAR IN SIZE
TO BROWNING
JS5 COUPLING

SS – Type

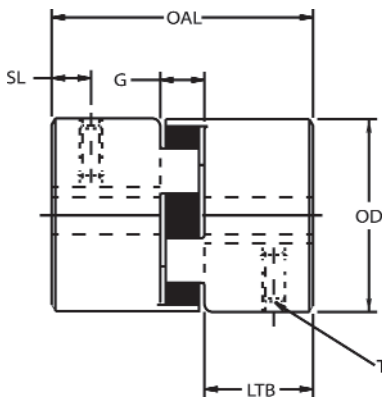

Stainless Steel Coupling Ratings – Chart 2

Size	Material	Torque Rating		HP/100	Maximum Bore		Max RPM
		in-lbs	Nm		in	mm	
SS075	Spider (Sox)	90.00	10.17	0.140	0.75	19	11,000
	Urethane	135.00	15.26	0.280			3,600
	Hytrell	227.00	25.65	0.360			3,600
	Bronze	227.00	25.65	0.360			250
SS095	Spider (Sox)	194.00	21.92	0.310	1.12	28	9,000
	Urethane	291.00	32.90	0.465			3,600
	Urethane(JIS)	335.00	38.00	0.530			9,200
	Hytrell	561.00	63.38	0.890			3,600
	Bronze	561.00	63.38	0.890			250
SS100	Spider (Sox)	417.00	47.11	0.660	1.38	35	7,000
	Urethane	477.00	53.90	1.320			3,600
	Urethane(JIS)	560.00	63.00	0.890			7,700
	Hytrell	1134.00	128.12	1.800			3,600
	Bronze	1134.00	128.12	1.800			250
SS110	Spider (Sox)	792.00	89.48	1.260	1.62	42	5,000
	Urethane	1188.00	134.00	1.890			3,600
	Urethane(JIS)	1090.00	123.00	1.730			5,900
	Hytrell	2268.00	256.25	3.600			5,000
SS150	Bronze	2268.00	256.25	3.600	250		
	Spider (Sox)	1240.00	140.10	2.000	1.88	48	5,000
	Urethane	1860.00	210.00	3.000			3,600
	Urethane(JIS)	1810.00	205.00	2.870			5,200
	Hytrell	3708.00	418.95	5.900			5,000
Bronze	3708.00	418.95	5.900	250			

List Prices Per Hub

Size	Rough Stock Bore	Stock Finished Bore*	Non-Stock Finished Bore ⁽¹⁾
SS075	\$26.00	\$50.00	\$88.00
SS095	\$35.00	\$62.00	\$97.25
SS100	\$50.00	\$73.00	\$112.00
SS110	\$91.00	\$137.00	\$167.15
SS150	\$133.00	\$183.00	\$227.95

* see chart 3

⁽¹⁾ inch bores – per AGMA 9002-A86

metric bores – per DIN 7154, H7

DIN 6885, JS9

Stainless Steel Hub UPC Part Numbers – Chart 3

Prefix is 685144 –

Size	RSB*	1/4	1/2	5/8	3/4	7/8	1"	1-1/8	1-3/8
SS075	70001	70006	70007	70008	70009	70010	-	-	-
SS095	70002	70011	70011	70012	70013	70014	70015	70016	-
SS100	70003	-	-	-	70017	70018	70019	70020	70022

Size	RSB*	1"	1-1/8	1-3/8	1-1/2	1-5/8	1-3/4	1-7/8
SS110	70004	70023	70024	70026	70027	70028	-	-
SS150	70005	70029	70030	70032	70033	70034	70035	70036

*Rough bore must be passivated after re boring to prevent rust.

For more information on the Lovejoy Stainless Steel Jaw coupling contact us at (630) 852-0500 or visit our web site

www.lovejoy-inc.com



Item # 685144-70664 12/00